

I/RAP/KZ-10

TELAIO RAPTOR MOD. KZ 97/CH/11
RAPTOR CHASSIS MOD. KZ 97/CH/11

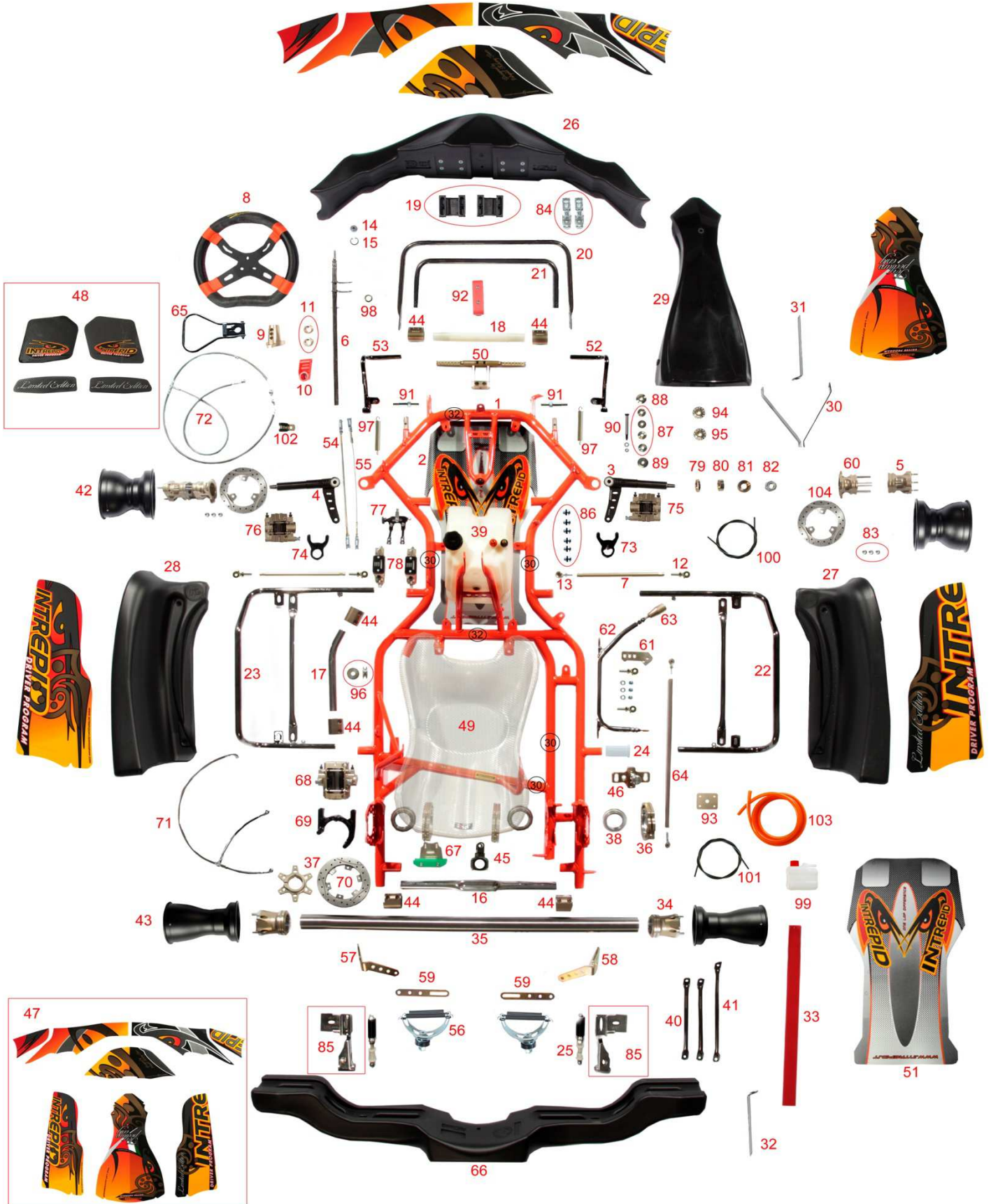

| Pos. Codice / Code | Descrizione / Description |
|-------------------------|--|
| 1 I/SIR/RAP-11 | SCocca RAPTOR Ø30mm <i>RAPTOR FRAME Ø30mm</i> |
| 2 I/INT0694-06 | PIANALE MOD. RACING <i>RACING FLOOR PLATE</i> |
| 3 I/INT1161SHND X-09 | FUSELLO DX Ø25mm H1 - CARBON CHROME <i>RIGHT SPINDLE Ø25mm H1 - CARBON CHROME</i> |
| 4 I/INT1161SHNSX- 09 | FUSELLO SX Ø25mm H1 - CARBON CHROME <i>LEFT SPINDLE Ø25mm H1 - CARBON CHROME</i> |
| 5 I/INT1064L75-08 | MOZZO ANTERIORE L.75mm - TITAN-GOLD <i>FRONT HUBS L.75mm - TITAN-GOLD</i> |
| 6 I/INT1039-08 | PIANTONE STERZO L.490mm CARBON CHROME <i>STEERING COLUMN L.490mm CARBON CHROME</i> |
| 7 I/INT0983-07 | BARRETTA STERZO L.270mm TITAN-GOLD <i>TIE ROD L.270mm TITAN GOLD</i> |
| 8 I/INT0144-05 | VOLANTE 4 RAZZE Ø330mm <i>STEERING WHEEL WITH 4 SPOKES Ø330mm</i> |
| 9 I/ST053TG-08 | MOZZO VOLANTE INCLINATO - 3 FORI - TITAN-GOLD <i>INCLINED STEERING WHEEL HUB - 3 HOLES - TITAN GOLD</i> |
| 10 I/ST079RS-05 | SUPPORTO PER PIANTONE STERZO - NYLON - 2FORI - ROSSO <i>STEERING COLUMN SUPPORT - NYLON - 2 HOLES - RED</i> |
| 11 I/ST001TG-08 | ANELLO DI FERMO PIANTONE TITAN-GOLD <i>STEERING LOCKING COLUMN BUSH TITAN GOLD</i> |
| 12 I/ST110DX-05 | UNIBALL M8 DX - AC <i>RIGHT UNIBALL M8 - AC</i> |
| 13 I/ST110SX-05 | UNIBALL M8 - SX - AC <i>LEFT UNIBALL M8 - AC</i> |
| 14 I/ST046-05 | UNIBALL PIANTONE STERZO PB8 <i>UNIBALL FOR STEERING COLUMN PB8</i> |
| 15 I/ST051-05 | SEEGER Ø22mm PER UNIBALL PIANTONE STERZO <i>SNAP RING Ø22mm FOR STEERING COLUMN UNIBALL</i> |
| 16 I/INT0014-05 | BARRA STABILIZZATRICE Ø28mm POST. <i>REAR STABILIZER ROD Ø28mm</i> |
| 17 I/INT1074-08 | BARRA STABILIZZATRICE Ø28mm LAT. <i>LATERAL STABILIZER ROD Ø28mm</i> |
| 18 I/INT0970-07 | BARRA STABILIZZATRICE Ø28mm ANT. - NYLON <i>NYLON FRONT STABILIZER ROD Ø28mm</i> |
| 19 I/INT0821-06 | KIT PLACCA FISSAGGIO SPOILER ANT. FP7/CIK17 <i>FASTENING KIT FOR FRONT SPOILER MOD. FP7/CIK17</i> |
| 20 I/INT0840-06 | PARAURTI ANT. SUPERIORE MOD. FP7/CIK17 <i>HIGHER FRONT BUMPER MOD. FP7/CIK17</i> |
| 21 I/INT0841-06 | PARAURTI ANT. INFERIORE MOD. FP7/CIK17 <i>LOWER FRONT BUMPER MOD. FP7/CIK17</i> |
| 22 I/AR760DX-09 | SUPPORTO CARENATURA LAT. DX MOD. STILO CIK/14 <i>RIGHT SUPPORT FOR BODYWORK MOD. STILO CIK/14</i> |
| 23 I/AR760SX-09 | SUPPORTO CARENATURA LAT. SX MOD. STILO CIK/14 <i>LEFT SUPPORT FOR BODYWORK MOD. STILO CIK/14</i> |
| 24 I/INT0662-06 | BOCCOLA IN TEFLON PER ATTACCO PARAURTI LATERALE <i>FASTENING WASHER IN TEFLON FOR LATERAL BUMPER</i> |
| 25 I/INT0677TG-08 | KIT ATTACCO PARAURTI POST. Ø30mm BOCCOLE - TITAN-GOLD <i>REAR BUMPER FASTENING KIT Ø30- TEFLON WASHERS TITAN-GOLD</i> |
| 26 I/AR750NR-09 | SPOILER ANTERIORE MOD. FP7/CIK17 <i>FRONT SPOILER MOD. FP7/CIK17</i> |
| 27 I/AR759NRDX-09 | CARENATURA LATERALE DX MOD. STILO CIK/14 <i>RIGHT BODYWORK MOD. STILO CIK/14</i> |
| 28 I/AR759NRSX-09 | CARENATURA LATERALE SX STILO CIK/14 <i>LEFT BODYWORK MOD. STILO CIK/14</i> |
| 29 I/AR752NR-09 | FRONTALINO PORTANUMERO MOD. FP7/CIK17 <i>FIXING KIT FOR LATER BODYWORK MOD. STILO CIK/14</i> |
| 30 I/INT0819-06 | COPPIA SUPPORTO SUP. FRONTALINO <i>UPPER COUPLE FOR NUMBER PLATE HOLDER</i> |
| 31 I/INT1009-07 | SUPPORTO INFERIORE FRONTALINO <i>LOW SUPPORT FOR NUMBER PLATE HOLDER</i> |
| 32 I/AR086-05 | STAFFA SUPPORTO PARACATENA KZ <i>SUPPORT CLAMP FOR CARTER CHAIN GUARD</i> |

| | | |
|----|-----------------|---|
| 33 | I/AR085-05 | PARACATENA PER KZ <i>CHAIN GUARD FOR KZ</i> |
| 34 | I/INT1034L95-08 | MOZZO POST. ALLUMINIO Ø50X95mm TITAN-GOLD <i>REAR HUB Ø50X95mm TITAN-GOLD</i> |
| 35 | I/INT2-30 | ASSALE Ø50 - 1030mm MOD. T2 - UNIVERSALE <i>UNIVERSAL AXLE Ø50 - 1030mm MOD. T2</i> |
| 36 | I/INT1035-08 | GUSCIO PORTACUSCINETTO Ø50mm TITAN-GOLD <i>BEARING BUSH SUPPORT Ø50mm TITAN-GOLD</i> |
| 37 | I/INT1037-08 | PORTADISCO Ø50mm TITAN-GOLD <i>DISK SUPPORT Ø50mm TITAN-GOLD</i> |
| 38 | I/CU017-08 | CUSCINETTO PER ASSALE Ø50X80mm / 3 GRANI <i>AXLE'S BEARING Ø50X80mm / 3 PINS</i> |
| 39 | I/AR277-05 | SERBATOIO "ANTISBATTIMENTO" 8,5L. MOD. KG <i>"ANTISHAKING" TANK 8,5L. MOD. KG</i> |
| 40 | I/AR755-09 | RINFORZO SEDILE TONDO L.320mm - CROMATO <i>CHROMED ROUND SEAT SUPPORT L.320mm</i> |
| 41 | I/AR756-09 | RINFORZO SEDILE TONDO L.340mm - CROMATO <i>CHROMED ROUND SEAT SUPPORT L.340mm</i> |
| 42 | I/CE104MG-10 | CERCHIO ANTERIORE Ø132mm MOD. DOUGLAS - NERO <i>FRONT RIM Ø132mm MOD. DOUGLAS - BLACK</i> |
| 43 | I/CE103MG-10 | CERCHIO POSTERIORE Ø212mm MOD. DOUGLAS - NERO <i>REAR RIM Ø212mm MOD. DOUGLAS - BLACK</i> |
| 44 | I/AR197ALTG-08 | FASCETTA STRINGITUBO Ø28mm - AL - TITAN-GOLD <i>TIGHTENING PIPE BELT Ø28mm - AL - TITAN-GOLD</i> |
| 45 | I/GT017TG-05 | SUPPORTO Ø30MM PER POMPA ACQUA - TITAN-GOLD <i>Ø30mm WATER PUMP SUPPORT - TITAN-GOLD</i> |
| 46 | I/INT1094-08 | SPINGIMOTORE COMPLETO <i>CHAIN STRETCHER</i> |
| 47 | I/INT1129-08 | KIT ADESIVI CARENATURE <i>COMPLETE STICKERS KIT</i> |
| 48 | I/INT1130-08 | KIT ADESIVI SERBATOIO <i>STICKERS KIT FOR FUEL TANK</i> |
| 49 | I/INT0896-06 | SEDILE MOD. RACING SILVER <i>SEAT MOD. RACING SILVER</i> |
| 50 | I/INT0992-07 | SISTEMA POGGIPIEDI REGISTRABILE <i>ADJUSTABLE FOOTREST SYSTEM</i> |
| 51 | I/INT0971-07 | ADESIVO INTREPID PER PIANALE <i>STICKER FOR FLOOR PLATE</i> |
| 52 | I/INT0967-07 | PEDALE ACCELERATORE - CROMATO <i>CHROMED ACCELERATOR PEDAL</i> |
| 53 | I/INT0968-07 | PEDALE FRENO - CROMATO <i>CHROMED BRAKE PEDAL</i> |
| 54 | I/FR354-05 | KIT COMPLETO TIRANTE FRENO - M6X410 <i>CHROMED TIE ROD - M6X410</i> |
| 55 | I/FR105-05 | CAVO DI SICUREZZA L.350mm <i>SAFETY STEEL CABLE L.350mm</i> |
| 56 | I/AR181-05 | CULLA MARMITTA COMPLETA DI MOLLE <i>COMPLETE SILENCER HOLDER</i> |
| 57 | I/INT1118-08 | SUPPORTO CULLA MARMITTA SX - TRATTAMENTO GIALLO <i>LEFT SILENCER HOLDER - YELLOW TRATMENT</i> |
| 58 | I/INT1119-08 | SUPPORTO CULLA MARMITTA DX - TRATTAMENTO GIALLO <i>RIGHT SILENCER HOLDER - BLACK YELLOW TRATMENT</i> |
| 59 | I/INT1120-08 | STAFFA PER SUPPORTO CULLA MARMITTA - TRATTAMENTO GIALLO <i>SUPPORT BRACKET FOR SILENCER HOLDER - YELLOW TRATMENT</i> |
| 60 | I/INT1065-08 | PORTA DISCO ANTERIORE KZ - R2 TITAN-GOLD <i>FRONT DISC SUPPORT KZ - R2 TITAN-GOLD</i> |
| 61 | I/INT0713-06 | ADATTATORE LEVA CAMBIO <i>GEAR LEVER ADAPTER</i> |
| 62 | I/INT0994-07 | LEVA CAMBIO CROMATA <i>CHROMIUM PLATED GEAR LEVER</i> |
| 63 | I/INT0993TG-09 | POMELLO LEVA CAMBIO ANOD. TITAN-GOLD <i>GEAR LEVER HANDLE - TITANIUM</i> |
| 64 | I/AR101TG-08 | ASTA CAMBIO ESAGONALE L.495mm - TITAN-GOLD <i>HEXAGONAL L 495mm GEAR ROD AL - TITAN-GOLD</i> |
| 65 | I/AR099-05 | LEVA FRIZIONE E SUPPORTO - CROMATA <i>CLUCHT LEVER AND SUPPORT - CHROMIUM PLATED</i> |

| | | |
|----|----------------|--|
| 66 | I/AR608-06 | PARAURTI POSTERIORE IN PLASTICA MOD. KG CON KIT ATT. <i>PLASTIC REAR BUMPER MOD. KG WITH SUPPORT KIT</i> |
| 67 | I/INT1135-09 | PROTEZIONE DISCO FRENO POSTERIORE <i>REAR BRAKE DISK PROTECTOR KIT</i> |
| 68 | I/INT1052-08 | PINZA FRENO POSTERIORE R1/R2/FRM.R1 109/108/185/FR/14 <i>REAR BRAKE CALIPER R1/R2/FRM.R1 109/108/185/FR/14</i> |
| 69 | I/INT1063-08 | SUPPORTO PINZA POSTERIORE R1/R2 - AL - NERO <i>REAR BRAKE CALIPER SUPPORT R1/R2 - AL - BLACK</i> |
| 70 | I/INT1054-08 | DISCO FRENO POSTERIORE R1/R2 <i>REAR BRAKE DISC R1/R2</i> |
| 71 | I/INT1051-08 | KIT TUBO FRENO POSTERIORE R1/R2 <i>REAR BRAKE TUBE R1/R2</i> |
| 72 | I/INT1061-08 | KIT TUBO FRENO ANTERIORE R2 <i>FRONT BRAKE TUBE R2</i> |
| 73 | I/INT1073DX-08 | SUPPORTO PINZA ANT. DX R2 - NERO <i>FRONT CALIPER PLATE SUPPORT R2 - RIGHT - BLACK</i> |
| 74 | I/INT1037SX-08 | SUPPORTO PINZA ANT. SX R2 - NERO <i>FRONT CALIPER PLATE SUPPORT R2 - LEFT - BLACK</i> |
| 75 | I/INT1057DX-08 | PINZA FRENO ANT. DX R2 108/FR/14 <i>FRONT BRAKE CALIPER R2 - RIGHT - 108/FR/14</i> |
| 76 | I/INT1057SX-08 | PINZA FRENO ANT. SX R2 108/FR/14 <i>FRONT BRAKE CALIPER R2 - LEFT - 108/FR/14</i> |
| 77 | I/FR046-05 | RIPARTITORE DI FRENATA IN ERGAL - LEVE FISSE <i>ERGAL BRAKING DISTRIBUTION - FIXED LEVERS</i> |
| 78 | I/INT0103-05 | POMPA FRENO Ø19mm R1/R2 <i>BRAKE PUMP Ø19mm R1/R2</i> |
| 79 | I/FS036-06 | SPESSORE FUSELLO Ø25X5mm - GIALLO <i>SPINDLE LINING Ø25X5mm - YELLOW</i> |
| 80 | I/FS037-06 | SPESSORE FUSELLO Ø25X10mm - GIALLO <i>SPINDLE LINING Ø25X10mm - YELLOW</i> |
| 81 | I/FS038-06 | RONDELLA Ø25mm PER CHIUSURA MOZZO <i>STEEL WASHER Ø25mm FOR HUB LOCKING</i> |
| 82 | I/FS008-05 | DADO M14X1,5mm AUTOBLOCCANTE <i>SELFLOCKING NUT M14X1,5mm</i> |
| 83 | I/INT1092-08 | KIT BOCCOLE FLOTTANTI PORTADISCO ANT. R2 <i>FLOATING BUSH KIT FOR FRONT DISC SUPPORT R2</i> |
| 84 | I/INT2013-01 | KIT GANCI ATTACCO SPOILER ANTERIORE 2 PZ. <i>CLAMP KIT FOR FRONT SPOILER 2 PZ.</i> |
| 85 | I/INT2013-02 | KIT SUPPORTO PARAURTI POST. 2 PZ. <i>SUPPORT KIT FOR REAR BUMPER 2 PZ.</i> |
| 86 | I/INT2013-03 | KIT VITI CON GOMMINO PER FISSAGGIO PIANALE 6 PZ. <i>SCREW KIT WITH RUBBER WASHER FOR FLOOR PLATE 6 PZ.</i> |
| 87 | I/INT0734-06 | RONDELLA PER REGOLAZIONE FUSELLO Ø10 <i>HIGH REGULATION SPINDLE WASHER Ø10</i> |
| 88 | I/INT0956-07 | BOCCOLA DRITTA SUPERIORE <i>UPPER STRAIGHT BUSH</i> |
| 89 | I/INT0957-07 | BOCCOLA DRITTA INFERIORE <i>LOWER STRAIGHT BUSH</i> |
| 90 | I/INT0794-06 | VITE FUSELLO Ø10 <i>SPINDEL SCREW Ø10</i> |
| 91 | I/INT2013-04 | VITE ATTACCO PEDALE <i>PEDAL'S SREW</i> |
| 92 | I/INT2013-05 | COPPIA FISSAGGIO PARAURTI ANT. - PLASTICA - ROSSA 6 PZ. <i>COUPLE OF JOINTS FOR FRONT SPOILER - PLASTIC - RED 6 PZ.</i> |
| 93 | I/INT2013-07 | PIASTRINA ATTACCO SEDILE - ALLUMINIO <i>SEAT'S PLATE CONNECTION - ALUMINIUM</i> |
| 94 | I/INT1010-07 | BOCCOLA ECCENTRICA SUPERIORE 1° - GIALLA <i>UPPER HEAD ECCENTRIC BUSH 1° - YELLOW</i> |
| 95 | I/INT1011-07 | BOCCOLA ECCENTRICA INFERIORE 1° - GIALLA <i>LOWER HEAD ECCENTRIC BUSH 1° - YELLOW</i> |
| 96 | I/AR216TG-05 | SPESSORE SEDILE Ø30XØ10X10mm - TITAN GOLD <i>SEAT LINING Ø30XØ10X10mm - TITAN GOLD</i> |
| 97 | I/AR093-05 | MOLLA PEDALE ZINCATA <i>PEDAL SPRING - GALVANIZED</i> |
| 98 | I/INT2013-08 | SPESSORE UNIBALL PIANTONE STERZO <i>UNIBALL LINING FOR STEERING WHEEL</i> |



| | | |
|-----|--------------|--|
| 99 | I/INT2013-09 | SERBATOIO DI RECUPERO <i>RECOVER TANK</i> |
| 100 | I/AR140NR-05 | GUAINA PER CAVO ACCELERATORE - COL. NERO <i>ACCELERATORE SHEATH WIRE - BLACK</i> |
| 101 | I/AR141NR-05 | GUAINA PER CAVO FRENO/FRIZIONE - COL. NERO <i>SHEATH BRAKE/CLUTCH WIRW - COL. BLACK</i> |
| 102 | I/FR097-05 | FASCETTA FISSAGGIO TUBO FRENO - Ø8mm <i>BRAKE PIPE FIXING BELT - Ø8mm</i> |
| 103 | I/AR078-05 | TUBO BENZINA Ø5X10mm - MT. 1 <i>FUEL PIPE - Ø6X9mm - EACH METER</i> |
| 104 | I/INT1062-08 | DISCO FRENO ANTERIORE R2 <i>FRONT BRAKE DISC R2</i> |